

MIDDLETON ASSOCIATES INCORPORATED
1702 W. COLLEGE AVE., SUITE E
NORMAL, IL 61761-2793
PHONE 309/452-1271 FAX 309/454-8049

SPECIFICATIONS FOR LABOR AND MATERIALS

FOR

EUGENE FIELD SPECIAL SERVICE CENTER
ASBESTOS ABATEMENT 2020 RENO
412 E. CYPRESS STREET, NORMAL, IL 61761

FOR

MCLEAN COUNTY UNIT DISTRICT NO. 5
1809 HOVEY AVENUE
NORMAL, ILLINOIS 61761-4339

PROJECT NUMBER: 24952319

ISSUE DATE: Monday, April 27, 2020

PRE-BID MEETING

By Appointment: EUGENE FIELD SPECIAL SERVICE CENTER
412 E. CYPRESS STREET, NORMAL, IL 61761
Meet at Main entrance

BID DATE: Tuesday, May 5, 2020 – 1:30 p.m.

BID DELIVERED TO: Unit 5 Maintenance Warehouse
1999 Eagle Road
Normal, IL 61761

SPECIFICATION BOOKLET NO. _____



Expiration Date
11/30/20

A handwritten signature in black ink, appearing to read "Randall E. Middleton", written over a horizontal line.

[Seal and Signature]

DIVISION 0 – BIDDING & CONTRACT REQUIREMENTS

Section 00040 – Instructions for Bidders

1. GENERAL

1.1. LOCATION OF THE PROJECT:

- A. **Eugene Field Special Service Center, Asbestos Abatement 2020
Reno, 412 E. Cypress Street, Normal, IL 61761**

1.2. GENERAL CONDITIONS:

- A. Schedule: Bid date Tuesday, May 5, 2020, 1:30 PM. The Ceiling and Floor ACM Abatement will occur from May 11, 2020 to May 22, 2020. This Project should start as soon after May 22 as possible. It is anticipated that this project will be finished by Wednesday, June 24, 2020.
- B. Owners Protective Bonds will not be required for this job. Proof of insurance for Workman's Comp. and General Liability Insurances must be provided.
- C. Contract Award will be in the form of Letter to Proceed.

1.3. BACKGROUND INVESTIGATION AND SEX OFFENDERS ON SCHOOL GROUNDS

- A. Illinois Criminal Background checks are applicable to this Contract. The Contractor or subcontractor shall only send construction workers to the site that have successfully passed an Illinois Criminal Background check, per 105 ILCS 5/10-21.9 and 105 ILCS 5/14-7.02
- B. The Contractor shall provide:
1. Prior to start of work; maintain a list available to the Owner of all the employees who will be or are anticipated will be employed on site. This list shall be updated when new persons not originally listed will be working on site. This list shall also include names of personnel employed by subcontractors.
 - a. Contractor insures that all persons have had background check paperwork initiated and sent to: Ann Fair, Unit 5 Maintenance Office, 1999 Eagle Road, Normal, IL 61761: Tel: 309-557-4100 or Fax: 309-557-4537.
 2. Persons temporarily on site such as truck drivers or employees making deliveries do not need to be listed, but the Owner reserves the right to request a background check.
 3. Provide an affidavit to the Owner that the Contractor or his subcontractor has performed an ISP background check by name on all personnel on site.
 4. Copies of employee lists and affidavits shall be promptly provided to the owner upon request.

- C. The Contractor shall not knowingly employ on school grounds any person who has not signed or will not sign an authorization for a criminal background check.
- D. The Owner reserves the right to run fingerprint background checks on any or all employees on site, randomly or specifically, and the cost of this check will be borne by the Owner. Upon request, provide information, which will not be shared, as needed to complete checks. This may include SSN, home addresses, fingerprint, address, etc. and any alias or former names used.
- E. The Contractor shall assume the responsibility to notify all on site employees or potential employees of this provision, and of the consequences of this provision.

1.4. SUBSTANCE ABUSE PREVENTION ACT ON PUBLIC WORKS PROJECTS

- A. The Contractor shall comply with 820 ILCS 265/ which establishes a process for Drug Abuse on Public Projects. The Contractor shall have in place a written program that meets the requirement of this Act.

1.5. TOBACCO AND ALCOHOL FOR CONSUMPTION PRODUCTS

- A. Smoking, chewing, etc. shall not be permitted anywhere on school property by State Statute.
- B. Alcoholic beverages are not allowed on school property.
 - 1. Working under the influence of anything containing alcohol or any prescription or non-prescription drug is not allowed on the job site.
- C. Violators may be removed from the job sites subject to conditional return privileges in the future.

1.6. SEXUAL HARASSMENT POLICY

- A. The Owner will not tolerate sexual harassment in any form. Sexual harassment is defined, for the purpose of this policy, as "unsolicited, deliberate or repeated sexually derogatory statements, gestures or physical contact, which cause discomfort or humiliation. Sexual harassment may involve pressure from a person of either sex against a person of the opposite sex or same sex . . ."
 - 1. Should evidence that a Contractor, or a Contractor's employee, has harassed a student or other individuals, the harasser shall be removed from the job site.

1.7. EMPLOYEE-STUDENT RELATIONSHIPS

- A. Except in an emergency situation involving safety, intermingling of the

Contractors' employees and the school faculty, staff and students is be avoided. Contractor or Subcontractor personnel violating this requirement shall be removed from employment at this site. The Contractor Superintendent shall monitor this to the best of his ability. Contractor employees experiencing problems with students or faculty shall report same to their Project Superintendent, who shall promptly report the problem to an authorized representative of the Owner and the Architect/Engineer.

1. Avoid profanity and inappropriate subject matter in conversation as students and staff may be within audible range and walls or ceiling spaces may allow sound transmission.
2. Verbal or physical action interpreted as sexual in nature or as sexual harassment will be grounds for removal of the employee. Further legal action remains the option of the persons affected.
3. In all aspects of this provision, the Contractor's employees as adults have the greater responsibility and should not respond to inappropriate student behavior.

- 1.8. This is a project requiring the payment of prevailing wages. Proper written notification as required under Public Act 96-0437:

This contract calls for the construction of a "public work," within the meaning of the Illinois Prevailing Wage Act, 820ILCS 130/.01 *et seq.* ("the Act"). The Act requires contractors and subcontractors to pay laborers, workers and mechanics performing services on public works projects no less than the current "prevailing rate of wages" (hourly cash wages plus amount for fringe benefits) in the county where the work is performed. The Department publishes the prevailing wage rates on its website at <http://labor.illinois.gov/>. The Department revises the prevailing wage rates and the contractor/subcontractor has an obligation to check the Department's web site for revisions to prevailing wage rates. For information regarding current prevailing wage rates, please refer to the Illinois Department of Labor's website. All contractors and subcontractors rendering services under this contract must comply with all requirements of the Act, *including but not limited to*, all wage requirements and notice of record keeping duties.

END 00040

1. GENERAL

1.1. WORK INCLUDES

- A. Base Bid: Provide acoustical ceiling work as shown on the Drawings and specified herein.
1. Install new grid and 2 X 2 panels in Rooms 16, 17 and 100.9;
 2. Existing plaster ceilings will be removed by IDEAL Environmental Inc. (call Kyle Cotton (217)412-5991).
 3. Remove and reinstall existing light fixtures in Rooms 16 and 17. Existing light fixtures in Corridor 100.9 to be disconnected from power, removed with ceiling and new fixtures installed in Corridor 100.9.

1.2. QUALITY ASSURANCE

- A. Acoustical material shall conform with the following minimum requirements:
1. Sound Absorption: ASTM CA23-66, NRC .50-.60.
 2. Sound Attenuation: AIMA, Test I-II, 35-39 range.
 3. Light Reflectance: ASTM C 523-68, .70-.74. (LR-1).
 4. Flame Spread:
 - a. Materials shall neither ignite nor flame when inserted into a furnace heated to and maintained at 1200 degrees F. for a period of five (5) minutes.
 - b. Additionally, interior finish or decorative materials applied to ceiling surfaces and ceiling materials shall not be permitted if they give off smoke or gases more dense or more toxic than given off by untreated wood or untreated paper under comparable exposure to heat or flame.
 5. Fire rated materials: Underwriter's Laboratories, Inc. Design P-202 RC13-1 Hour except spring clips are not required.
 6. **Humidity resistance and mold resistance.**

1.3. DELIVERY, STORAGE AND HANDLING

- A. Deliver materials to the project site in Manufacturer's unopened containers clearly indicating Manufacturer's name, brand, type, style, size, color, texture and other identifying information.
- B. Store materials in a dry location, off the ground and in a manner to prevent damage, deterioration, and intrusion of foreign matter. Replace materials, which have been damaged or are otherwise unsuitable promptly.

2. PRODUCTS

2.1. MATERIALS

- A. Acoustical Tile: Fissured surface, mineral fiber tile, fire code rated, 24" X 24" X 5/8", square edged, one (1) hour UL rated in assembly also meeting ASTM E-84 and ASTM E-119 of material certified to contain no asbestos.
1. USG
 2. Conwed Corp.
 3. Celotex Corp. – Fine Fissured
 4. Armstrong
 - a. Humidity rated non-sag 100 deg. F./90% R.H.
 - b. Fine fissured, match existing building for directional or non-directional style.
 - c. STC Range 4-44
 - d. LR1 (75% minimum)
 - e. R thermal value = 1.36
 - f. 1 hour UL rated
 - g. Physically compatible with one (1) hour rated suspension system.
- B. Suspended Grillage
1. Hangers: Minimum 12-gauge, soft annealed, steel wire, galvanized. See paragraph F. below.
 2. Provide support at 48" on center along main runners.
 - a. Provide necessary sub-framing where needed to achieve 48" support spacing under ducts, openings, etc.
- C. Snap Grid System
1. One (1) hour rated type grid, hold-down clips are not required.
 2. Main Runners: 3/4" high, minimum 0.020" thick steel sheet formed runner with outstanding leg at top and tee shape at bottom.
 3. Splines: Flat, steel minimum 11/16" wide, 0.020" thick.
 4. Clips: Steel wire clips to hold main runner to carrying channels.
 5. White face finish
- D. Metal Wall Moldings: Galvanized sheet steel, angles or channels, minimum 0.020" thick, chemically cleaned, bonderized and finished with snap on white aluminum face finish, ASTM C 636-76.
- E. #12 Eyelet Head Screws: Length as needed for wire hanger anchors.
- F. Hanging wire #10 gauge galvanized soft annealed wire.
- G. New light fixtures in Corridor 100.9 – (4) required.
1. Provide and install.
 2. See attached sheet.

3. EXECUTION

3.1. PREPARATION

- A. Examine all surfaces to receive the parts of work specified herein.
- B. Verify all dimensions of in-place and subsequent construction. Application or; installation of materials constitutes acceptance of the supporting construction.

3.2. INSTALLATION OF MECHANICAL SUSPENSION SYSTEMS

- A. Install suspension system in accord with ASTM C636-76 and current AIMA recommended procedures.
- B. Unless otherwise shown or recommended closer by the system's manufacturer, install hangers to construction above a maximum four feet (4') o.c. in rows four feet (4') apart.
 - 1. All hangers shall hang in plumb position.
 - 2. Supporting runners typically shall run perpendicular to the structural members.
- C. Extend wire hangers downward.
 - 1. At proper elevation wrap hangers around carrying channels and secure each hanger with at least three (3) turns.
 - 2. Hanger wires shall be vertical. Wires installed at a diagonal to reach a structural member shall be balanced with diagonal ties in the opposite direction to brace the grid against side loading.
- D. Coordinate spacing of hangers, carrying channels, runners and moldings with the location of electrical fixtures and other items occurring in or on the ceiling.
 - 1. The ceiling lighting fixture locations shall determine the ceiling grid pattern.
 - 2. Provide hanger wires to structure for cross runners around light fixtures. Each fixture shall have a minimum of four (4) tie wires within eight inches (8") of each fixture corner.

3.3. INSTALLATION OF TILE

- A. Installation of acoustical materials shall be done under temperature and relative humidity conditions that will exist when the building is occupied. Building shall be closed in and operating on permanent equipment such that temperature and humidity will be maintained at a constant and normal level.
- B. The entire installation shall be free of damage of any sort at the completion

of the Contract. All system sections deflecting in excess of 1/240th of the span or length shall be replaced.

- C. At a time and following installation the building shall be kept at a constant temperature and DOOR TO EXTERIOR KEPT CLOSED, ventilating system functional, filters in place.

3.4. CLEANING AND PROTECTION

- A. Upon completion of the work remove all unused materials, debris, containers and equipment from the project site. Clean and repair floors, walls and other surfaces that have been stained, marred or otherwise damaged by work under this section.
- B. Protect acoustical ceilings during the construction period so that they will be without any indication or deterioration or damage at the time of acceptance by the Owner.

END 09500

Catalog Number	BLWP2 20L APP GZ1 LP840
Notes	FIXTURE ①
Type	24" LENGTH - 4 REQUIRED

FEATURES & SPECIFICATIONS

INTENDED USE — The BLWP LED Wrap/Wall bracket expands the BLT family with the features and aesthetics of the popular BLT and BLTR center basket design with a clean, versatile style and volumetric distribution. High efficacy LED light engines deliver energy savings and low maintenance compared to traditional sources. An extensive selection of configurations and options make the BLWP the perfect choice for many lighting applications including schools, offices, stairwells and other commercial spaces. With multiple mounting options, easy installation, and controls configurations, the BLWP is an excellent choice for renovation and new construction.

CONSTRUCTION — BLWP enclosure components are die-formed for dimensional consistency. For 2' and 4' product, hinged door frame allows easy access to electrical components and mounting locations without having to remove additional parts. For 8' product, suspension aircraft cables allow easy access to electrical components and mounting locations without having to remove additional parts. Available in three paint finishes: white (pre-paint), painted after fabrication white, and natural aluminum. Diffusers are extruded from impact modified acrylic for increased durability. Optional polycarbonate lens available for additional impact resistance, as well as Tamper Proof screws.

OPTICS — Volumetric illumination is achieved by creating an optimal mix of light to walls, partitions and vertical and horizontal work surfaces — rendering the interior space, objects and occupants in a more balanced, complimentary luminous environment. High performance extruded acrylic diffusers conceal LEDs and efficiently deliver light in a volumetric distribution. Five diffuser choices available - curved and square designs with ribbed, a smooth frosted finish, and a smooth polycarbonate finish.

ELECTRICAL — Long-life LEDs, coupled with high-efficiency drivers, provide superior quantity and quality of illumination for extended service life. 80% LED lumen maintenance at 60,000 hours (L80/60,000). Replaces 2 lamp fluorescent.

Configurable BLWP: Available in High Efficiency (HE) versions for applications where a lower wattage (over the standard product) is required. The High Efficiency versions deliver >130 LPW and can be specified via the Lumen Package designations in the Ordering Information on page 2.

LED driver options deliver choice of dimming range, and choices for control, while assuring flicker-free, low-current inrush, 89% efficiency and low EMI.

Optional integrated nLight® controls make each luminaire addressable - allowing it to digitally communicate with other nLight enabled controls such as dimmers, switches, occupancy sensors and photocontrols. Connection to nLight is simple. It can be accomplished with integrated nLight AIR wireless or through standard Cat-5 cabling. nLight offers unique plug-and-play convenience as devices and luminaires automatically discover each other and self-commission, while nLight AIR is commissioned easily through an intuitive mobile app.

Lumen Management: Unique lumen management system (option N80) provides on board intelligence that actively manages the LED light source so that constant lumen output is maintained over the system life, preventing the energy waste created by the traditional practice of over-lighting.

Driver disconnect provided where required to comply with US and Canadian codes.

CONTROLS — **Integrated sensor (individual control):** Sensor Switch MSD7ADCX (Passive infrared (PIR)) or MSDPDT7ADCX (PIR/Microphonics Dual Tech (PDT)) integrated occupancy sensor/automatic dimming photocell allows the luminaire to power off when the space is unoccupied or enough ambient light is entering the space.

Integrated Sensor (nLight Wired Networking): This sensor is nLight-enabled, meaning it has the ability to communicate over an nLight network. When wired, using CAT-5 cabling, with other nLight-enabled sensors, power packs, or WallPods, an nLight control zone is created. Once linked to a Gateway, directly or via a Bridge, the zone becomes capable of remote status monitoring and control via SensorView software. See page 5 for the nLight sensor options.

Integrated Smart Sensor (nLight AIR Wireless Platform): The rES7 sensor is nLight AIR enabled, meaning it has the ability to communicate over the wireless nLight control platform. It is available with an automatic dimming photocell, and either a digital PIR or dual technology occupancy sensor. It pairs to other luminaires and wall switches through our mobile app, CLARITY PRO, which allows for simple sensor adjustment. See page 5 for more details on the Integrated Smart Sensor.

INSTALLATION — Intended for surface or suspend mounting. For row mounting and quick mounting to junction boxes see accessories section. Suitable for damp location.

LISTINGS — CSA Certified to meet U.S. and Canadian standards.

DesignLights Consortium® (DLC) Premium qualified product. Not all versions of this product may be DLC Premium qualified. Please check the DLC Qualified Products List at www.designlights.org/DLP to confirm which versions are qualified.

WARRANTY — 5-year limited warranty. Complete warranty terms located at: www.acuitybrands.com/support/customer-support/terms-and-conditions

Note: Actual performance may differ as a result of end-user environment and application. All values are design or typical values, measured under laboratory conditions at 25 °C. Specifications subject to change without notice.

Low Profile LED Wraparound

BLWP

2', 4' and 8' Lengths



Specifications

2' Dimensions
 Length: 24 (60.96)
 Width: 5.50 (13.97)
 Depth: 3.50 (8.89)



4' Dimensions
 Length: 48 (121.92)
 Width: 5.50 (13.97)
 Depth: 3.50 (8.89)



8' Dimensions
 Length: 96 (243.84)
 Width: 5.50 (13.97)
 Depth: 3.50 (8.89)

All dimensions are inches (centimeters) unless otherwise specified.

A+ Capable Luminaire

This item is an A+ capable luminaire, which has been designed and tested to provide consistent color appearance and out-of-the-box control compatibility with simple commissioning.

- All configurations of this luminaire meet the Acuity Brands' specification for chromatic consistency
- This luminaire is part of an A+ Certified solution for nLight® or control networks marked by a shaded background*
- This luminaire is part of an A+ Certified solution for nLight control networks, providing advanced control functionality at the luminaire level, when selection includes driver and control options marked by a shaded background*

To learn more about A+, visit www.acuitybrands.com/aplus.

*See ordering tree for details

1. GENERAL

1.1. DESCRIPTION

- A. General Contractor shall furnish all labor and materials necessary to complete composite applied flooring in areas noted.
 - 1. New Floors in Corridors 100 and 100.9. New floors in Rooms 16, 17 (and area to North), 101, 101A 101B, 101C and 101D.
 - 2. Provide to owner 60 linear feet of 12" wide floor tile (see 2.1.A. below) for repairing edge along window in Room 16 and 17 after window and HVAC replacement Summer of 2021.

1.2. PRODUCT HANDLING

- A. Transport all materials to job site in Manufacturer's labeled containers.

1.3. WARRANTY

- A. The Product Manufacturer shall exercise power of approval of installers.
 - 1. Installers shall have applied similar flooring products on at least five (5) prior projects.
- B. The Product Manufacturer shall warrant the finished installation for a period of three (3) years following Substantial Completion of the project.
 - 1. Abuse to the installation counter to use and maintenance recommendations (1.3.A.3 above) excepted.
- C. The Contractor shall warrant the installation for a period of two (2) years following Substantial Completion date.
 - 1. Abuse of the installation counter to use and maintenance recommendations (1.3.A.3. above) excepted.

2. PRODUCTS

2.1. MATERIALS

- A. Luxury vinyl composition (asbestos-free) Tile: 1/8" thick, 18" x 18" or 16" x 16" or similar standard colors for no pattern installation.
 - 1. Armstrong LVT with Diamond 10® technology reduced maintenance coating.
 - 2. Owner has chosen Natural Creations, Earthcuts Braco NA332 Putty. This is 12" x 24" tiles for entire floor surface.
- B. LVT flooring Glue

1. 20 mil wear layers.
- C. Adhesives: Adhesives shall be water and alkali resistant, complying with recommendations of resilient flooring manufacturer as applicable to substrate. Adhesive shall contain no asbestos.
1. Manufacturer's recommended adhesive, not less than:
 - a. Rated to 8 lbs. moisture vapor and 12-pH.
 - b. Or neutralize and seal floor for other selected adhesive system such that combined installed result can accommodate 8 lbs. vapor.
 - c. Products such as Henry 430 Clear Pro.
 - d. Use heavy duty adhesives for transition pieces, we have had these come loose due to inadequate bonding capacity.
- D. Skim coat: Rapid set, skim coat material as appropriate for conditions encountered following carpet removal, adhesive residue and general clean up.
1. Product Manufacturers
 - a. Ardex
 - b. Mapei
 - c. DryTek
 - d. Select product suitable to discovered conditions, to glue manufacturer and to tile manufacturer.
 2. Quick set, fast dry, feather edge or up to 1/8" no shrink, latex or similar modified for adhesion.
 3. Installation to be level and without trowel marks, delimitation or surface defect.
 4. Material to provide good bonding surface and alkali protection for new adhesives.
- E. Rubber Base: 1/8" gauge, coved, preformed corners,
1. Four inches (4") high in new areas, 4 1/4" high in all areas where old base is removed, (4" under lockers). Unless otherwise shown; color shall be selected from the full range of available standard colors.
 2. Afco
 3. Johnsonite
 4. Roppe
 5. Or equal
- F. Vinyl Edge/transition Strips: 1 1/2 " wide for tile
1. Afco
 2. Johnsonite
 3. Roppe
 4. Or equal

3. EXECUTION

3.1. PREPARATION

A. Existing conditions

1. Surfaces, always verify surface conditions in all locations for needed fillers or repair or deficiencies.
2. Prepare and clean all surfaces as appropriately to receive the new flooring.
 - a. Strip wax where new floors are glued over existing.

B. Fixed equipment

1. Lockers and casework, cut to fit, cut removals to the edge line for accurate fit.

C. Before installing resilient flooring, fill all cracks and holes and level depressions and skim coat with cement base surface preparation system.

1. Check for flush fit at drain and cleanout rims, grind if necessary or raise or bevel surfaces as appropriate.
2. It is intended that any or all surfaces be skim leveled

3.2. INSTALLATION

A. Typically tile selections are to split under doors unless there are extenuating conditions.

B. Generally, the transition to adjacent surfaces may take a leveling filler.

C. Where flooring types vary such as resilient to carpet or floating to carpet a transition strip will be required.

D. Transition strips should always be beveled with feather edges selected appropriately for the conditions.

E. Install tile and apply resilient base to floor or walls and cabinet bases respectively.

- a. Inspect surfaces prior to installation of floors and base. Do not apply to rough, dirty or unprepared surfaces.
- b. Corners shall be pre-formed.
- c. Cope inside base corners. Scribe bases accurately to abutting surfaces.
- d. Apply adhesive uniformly on the back surface of the base with a notched trowel, single or double ribbon of adhesive not acceptable.

F. Remove excessive adhesive in accord with the Flooring Manufacturer's instructions.

G. Install floating flooring per manufacturer's instructions, offset joints, generally perpendicular to the primary entrance,

- a. Carefully install and secure transition strips from floating to adhered or carpeted flooring

3.3. CLEANING & SEALING

1. Floors to be turned over mopped clean.

END 09670

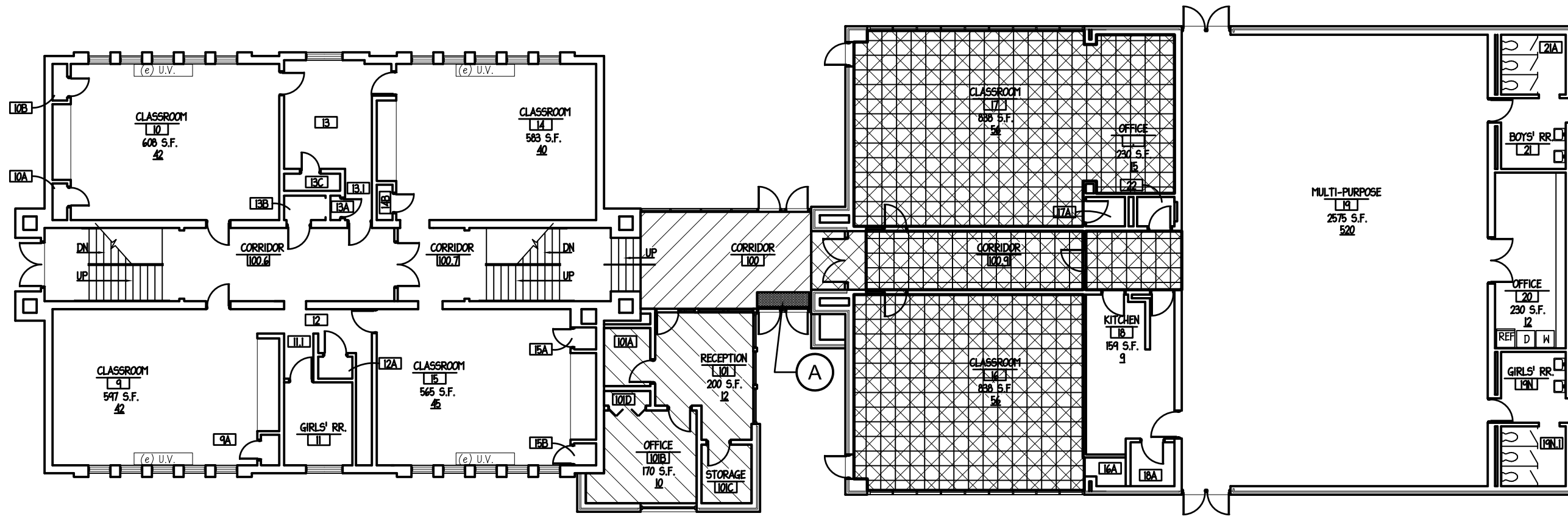

A RECESSED RUBBER FLOOR MAT - PROVIDE NEW
HARD RUBBER MAT - ULINE U-1681 PAGE 322

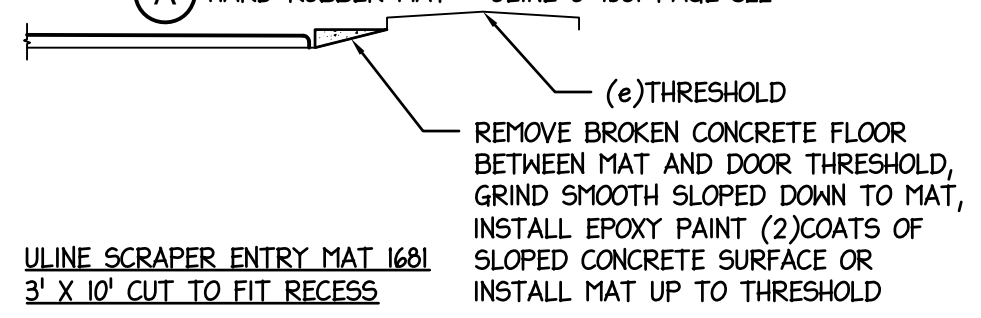

FIRST FLOOR PLAN

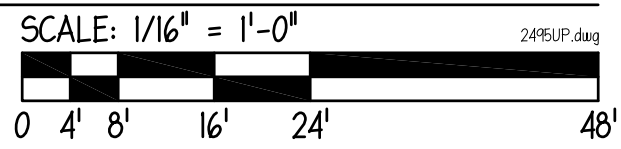

NOTE:
ACM CEILING REMOVAL AND ACM FLOOR REMOVAL UNDER SEPARATE CONTRACT ADMINISTERED BY IDEAL ENVIRONMENTAL INC. ph. KYLE COTTON (217) 412-5991

- LEGEND:**
- ARMSTRONG FLOORING, NATURAL CREATIONS 10 TECHNOLOGY EARTHCUTS BRACO NA332 PUTTY AND NEW CEILING LAY-IN 2X2 GRID
 - ARMSTRONG FLOORING, NATURAL CREATIONS 10 TECHNOLOGY EARTHCUTS BRACO NA332 PUTTY
 - ARMSTRONG FLOORING, NATURAL CREATIONS 10 TECHNOLOGY EARTHCUTS BRACO NA332 PUTTY

ASBESTOS ABATEMENT 2020 RENO		PROJECT NO. 24952319	ISSUE DATE APRIL 27, 2020	SHEET A1	OF 1 SHEETS
EUGENE FIELD SPECIAL SERVICES CENTER - 412 E. Cypress Street, Normal, IL 61761		MIDDLETON ASSOCIATES · INC ARCHITECTS <small>1702 W. College Ave. Suite E Normal, IL 61761-2793 P: 309.452.1271 F: 309.454.8049 middletonassociates.net</small>			
THE CONTRACTOR SHALL VERIFY CONDITIONS & DIMENSIONS ON THE JOB. INFORMATION SHOWN ON ANY PART OF THE DRAWINGS SHALL APPLY TO SIMILAR CONDITIONS AT OTHER LOCATIONS IN THE WORK UNLESS SET FORTH OTHERWISE					
NO.	DATE	REVISIONS	REMARKS		