

February 3, 2020

MIDDLETON ASSOCIATES INCORPORATED
1702 W. COLLEGE AVE., SUITE E
NORMAL, IL 61761-2793
309/452-1271 FAX 309/454-8049

ADDENDUM NUMBER 5
TO THE DRAWINGS AND SPECIFICATIONS

PROJECT: McLean County Unit District No. 5 Kingsley Junior High School HVAC Renovation
and Geothermal

FOR: McLean Co. Unit District No. 5, 1809 W. Hovey Ave., Normal, IL 61761

A/E PROJECT NO: 23152318

ISSUE DATE: January 14, 2020

BID OPENING: Thursday, February 6, 2020, 1:30 p.m. prevailing time
Maintenance Office, 1999 Eagle Road, Normal, IL 61761

THIS ADDENDUM DOES NOT CHANGE THE BID DATE OR BID TIME.

Upon receipt of this ADDENDUM, insert same into the documents, which were issued to you. Hereafter, said ADDENDUM shall be as much a part of the said documents as though originally set forth therein. THIS ADDENDUM DOES NOT CHANGE THE BID DATE.

23. TO THE SPECIFICATIONS, Section 28 3100: FIRE DETECTION AND ALARM:
Paragraph 1.01.A, B, & C: The fire alarm contractor is responsible for providing and installing duct smoke detectors and fire alarm relays for unit shutdown. The fire alarm contractor shall add the new devices to the existing fire alarm system as necessary to provide a complete and operational system.
24. TO THE SPECIFICATIONS, Section 28 3100: FIRE DETECTION AND ALARM:
Paragraph 2.03: Clarifications: In Building Area 2, duct detectors and relays on AHU S5, AHU-S7, AHU-S8, AHU-S9, and AHU-S10 will be demolished. In Building Area 2, AHU-S6, AHU-S11, AHU-S12, AHU-S13 will be demolished. In Building Area 4, AHU-2, AHU-3, AHU-4, AHU-5, AHU-6A (in Fan Room 140), and AHU-S8 will be demolished.
25. TO THE SPECIFICATIONS, Section 28 3100: FIRE DETECTION AND ALARM:
Paragraph 2.05 B. & C.: Any units over 2000 CFM would be required to have RA smoke detectors and relays to shut the units down. This would be HP-131A, HP-131B, HP-149A, HP-149B, HP-155A, HP-155B, HP-155C, HP-155D, ERU-1, ERU-2, and ERU-4.
26. TO THE SPECIFICATIONS, Section 00 3010: BID FORM: Replace Bid Form with the attached new Bid Form providing for ALTERNATE #1.
27. TO THE SPECIFICATIONS, Section 01 0300: Paragraph 1.2.A.: Delete the paragraph and add the following: A. ALTERNATE No. 1 This alternate will affect specifications Section 01 0100; Section 01 3516 Alteration Project Procedures; Section 09 5123

Acoustical Ceilings; Drawing D1.0; Drawing D1.1; Drawing A7.0; Drawing A7.1; Drawing E1.3; & E1.4.

1. At the South section of main corridor ceiling from the aluminum fire door south to the north wall of south "front" door; Remove and replace this grid and ceiling 94'x16'. Remove 11 1'x4' light fixtures (3 are being removed in Base Bid). Replace this ceiling as specified in Section 09 3516. Install one row of ten (10) new light fixtures 2BLT4 purchased by Unit District #5 and delivered to job site. Install two (2) occupancy sensors NCM 10RJB purchased by Unit 5.
 2. The main corridor to the exit lobby: Delete reinstalling original 1x4 fluorescent fixtures, and install 43 new light fixtures 2BLT4 purchased by Unit District #5 and delivered to job site on demand. Install 7 occupancy sensors purchased by Unit 5.
 3. The East-West corridor from cafeteria exit to the West exit: delete reinstalling six (6) 1'x4' light fixtures in Base Bid, and install five (5) new light fixtures 2BLT4 purchased by Unit 5.
 4. The East-West corridor from cafeteria to main corridor: (in the new mechanical area) delete reinstalling the original 1'x4' fluorescent in Base Bid, and install five (5) new LED TZL1N suspended light fixtures (no new grid being installed here as in Base Bid).
 5. The Northeast lobby; ceiling is not removed and reinstalled in Base Bid. In this alternate, existing ceiling to remain and six (6) existing 1'x4' fluorescent to be removed and replaced one for one with six (6) BLT4 LED fixtures. Also install new ceiling 4'x6' + 4'x6' where existing heating elements are removed.
 6. Orchestra Room 140 (H01): the perimeter ceiling is removed in Base Bid. In this alternate, remove the remaining 540 sq. ft. of ceiling in the center of the room and install new ceiling grid and panels meeting Specifications Section 09 5123. Do not reinstall 15 existing 2x4 fluorescent fixtures in Base Bid, instead install twelve (12) new 2BLT460L light fixtures purchased by Unit 5 and delivered on demand to job site.
 7. Four Counselor Rooms, Three Nurse Rooms, and Five Administrator Rooms: Delete reinstalling 33 original 2'x4' fixtures. Install twenty-five (25) new LED fixtures – seven (7) 2BLT460L in Counselor Rooms – two (2) 2BLDT40L in Sick Rooms – nine (9) 2'x4' LED fixtures in four Administration Rooms.
 8. Multi Purpose Room 1006: In this room, ceiling removal and removal of twenty-six (26) light fixtures included in this Alternate 1 price. Installation of new ceiling (grid and panels) is to be included in this Alternate 1 price. Installation of eighteen (18) 2BLT4N100 with manual dimming is to be included in this Alternate 1 price.
 9. There are a total of 66 occupancy sensors included in the suppliers list of material. The main corridor is accounted for, other locations will need to be clarified by Change Order.
28. TO THE SPECIFICATIONS, Section 26 2816 and TO THE DRAWING SHEET, M4.1.: All of the heat pumps with the manufacturer listed as Bard will have breakers for disconnects. All heat pumps with Waterfurnace listed as the manufacturer will not be provided with factory disconnects.

Attachments: Lighting Layout with Legend
Section 00 40 00 Bid Form (Revised)

END ADDENDUM NO. 5

PROJECT TITLE: Kingsley Junior High School HVAC Renovation and Geothermal
Kingsley Junior High School

BID DATE: Thursday, February 6, 2020 TIME: **1:30 p.m. Prevailing Time**

LOCATION OF BID: MAINTENANCE OFFICE
McLean County Unit District No. 5
1999 Eagle Rd.
Normal, IL 61761

NAME OF FIRM _____

PROPOSAL FOR: All work single contract

A/E PROJECT NO. 23152318

THE BID ACKNOWLEDGES THE FOLLOWING ADDENDA:
Failure to acknowledge may cause bid rejection

NO. 1 _____, NO. 2 _____, NO. 3 _____, NO. 4 _____ NO 5 _____

EACH BID SHALL INCLUDE:

- A. THE BID FORMS AND CERTIFICATIONS COMPLETED AND SIGNED, (*this form may be copied.*)
- B. BID SECURITY (*standard industry forms may be employed*)
- C. BIDS SHALL INCLUDE ALLOWANCE – SEE 00 24 13

**BASE BID – KINGSLEY JUNIOR HIGH SCHOOL HVAC RENOVATION AND GEOTHERMAL.
THE BIDDER AGREES TO PERFORM ALL BASE BID WORK, INCLUSIVE OF ALL TRADES
FOR THE SUM OF:**

_____ Dollars \$ _____
written amount

ALTERNATE 1: See Addendum #5

_____ Dollars \$ _____
written amount

- A. **Unit Price:** Remove existing ceiling grid and panels. \$ _____/sq. ft.
- B. **Unit Price:** Install new 2 x 2 grid ceiling;
see specification Section 09 51 23 \$ _____/lineal ft.
- C. **Unit Price:** Install new 2 x 2 ceiling panels;
see Section 09 51 23 \$ _____/sq. ft
- D. **Unit Price:** Remove and reinstall 1 x 4 or 2 x 4 light fixtures,
not adding new fixtures. \$ _____/unit

VOLUNTARY ALTERNATES OR SUBSTITUTIONS

Did you include voluntary alternates or product substitution offers on form provided.

YES _____

NO _____

1. SEE following section 00 40 10 Voluntary Alternate and Substitution Form. ATTACH IF ANY ARE OFFERED. Voluntary alternates or substitutions may or may not be considered in making the award and are not required.

THE BIDDER AGREES TO:

1. Hold this bid open for forty (40) calendar days after bid opening date.
2. Enter into and execute a contract with McLean County Unit District No. 5 if awarded this contract.
3. Comply with the contract and bidding documents with respect to bid security, all bonds, insurance, work requirements, schedule and Bonus / Penalty Clause
4. Comply with the Contract Documents with respect to Contract Time as specified in Scope of Bid Section 00 24 13.

THE BIDDER MAKES THE FOLLOWING REPRESENTATIONS AND CERTIFICATIONS:

- A. A surety company has agreed to issue payment and performance bonds to fulfill the contracting requirements.
- B. The Bidder is not barred from contracting with any unit of state or local government as a result of violating the bid rigging or bid rotating provisions contained in 720 ILCS 5/33E.
- C. The Bidder is not barred from contracting with the State of Illinois as a result of a bribery conviction per 30 ILCS 505/10.2.
- D. All on site labor and wage compensation provided by this contractor or his subcontractors will comply with the Illinois Prevailing Wage Act (820 ILCS 130E).
- E. This proposal is made without any connection with any person making another bid for the same contract, that the bid is in all respects fair and without collusion or fraud, that no member of the McLean County Unit District No. 5 School Board, other officer or any person in the employment of McLean County Unit District No. 5 is directly or indirectly interested in the bid or any portion of the profit there from, except as allowed by the Illinois Law or the Illinois School Code.
- F. I agree to provide a drug-free workplace as required by the Illinois Drug-free Workplace Act.
- H. I do hereby certify that I am either the bidder or duly authorized agent of the referenced bidder, and I am authorized to execute the certifications hereon.
- G. I certify that by submission of this proposal the bidder confirms that he is familiar with the site, existing conditions, the Bid Documents, requirements and the project schedule.

CONTRACTOR:

Firm Name: _____

Address: _____

FEIN: _____

Telephone: _____

Email:

FAX: _____

Date: _____

LIST OF SUBCONTRACTORS

SIGNATURE:

TITLE: _____
For Corporations only.

END 00 40 00

Schedule	Symbol	Label	Image	Quantity	Manufacturer	Catalog Number	Description	Lamp	Number Lamps	Wattage	Light Loss Factor	Efficiency	Distribution	Polar Plot	Notes	
	F1			2	Lithonia Lighting	26L14-48L-ADP-G210-LP840	2x4 LED Back Lit Troffer		1	26L14-48L-AD P_LP840.0m	5029	0.9	37.63	100%	DIRRECT, SC-D1.2, SC-90+1.27	
	F1A			2	Lithonia Lighting	26L14-48L-ADP-E21-LP840-N100	2x4 LED Back Lit Troffer with night mode		1	26L14-48L-AD P_LP840.0m	5029	0.9	37.63	100%	DIRRECT, SC-D1.2, SC-90+1.27	
	F2			6	Lithonia Lighting	8L74-48L-ADP-G210-LP840	1x4 LED Back Lit Troffer		1	8L74-48L-AD P_LP840.0m	4180	0.9	32.46	100%	DIRRECT, SC-D1.1R, SC-90+1.29	
	F3			15	Lithonia Lighting	26L14-48L-ADP-G210-LP840	2x4 LED Back Lit Troffer		1	26L14-48L-AD P_LP840.0m	4064	0.9	30.99	100%	DIRRECT, SC-D1.2, SC-90+1.27	
	F4			7	Lithonia Lighting	26L14-60L-ADP-G210-LP840	2x4 LED Back Lit Troffer		1	26L14-60L-AD P_LP840.0m	6112	0.9	46.41	100%	DIRRECT, SC-D1.2, SC-90+1.27	
	F4A			30	Lithonia Lighting	26L14-60L-ADP-G210-LP840-N100	2x4 LED Back Lit Troffer		1	26L14-60L-AD P_LP840.0m	6112	0.9	46.41	100%	DIRRECT, SC-D1.2, SC-90+1.27	
	F5			2	Lithonia Lighting	26L14-70L-ADP-G210-LP840	2x4 LED Back Lit Troffer		1	26L14-70L-AD P_LP840.0m	7360	0.9	56.74	100%	DIRRECT, SC-D1.2, SC-90+1.27	
	F6			5	Lithonia Lighting	T2L14-156-14-F21-TRUCK-48L-8000K-9L-6C	1' LED Strip with 3' Chain	LED	1	T2L14-156-14 F21-TRUCK-48L-8000K-9L-6C	12859	0.9	103.8	100%	DIRRECT, SC-D1.2, SC-90+1.17	
	OCC1			11	HLIGHT	HCN PFD 9	night Standard Range 360 Ceiling Mount Low Voltage Dual Technology Sensor		0	hcnpdr9.0m	Absolute	1	0	100%		
	OCC2			4	HLIGHT	HCN PFD 10	night Extended Range 360 Ceiling Mount Low Voltage Dual Technology Sensor		0	hcnpdr10.0m	Absolute	1	0	100%		
	OCC3			21	HLIGHT	HCN 10	Extended Range 360 Ceiling Mount Low Voltage Passive Infrared Sensor		0	hcn10.0m	Absolute	1	0	100%		
	WOCC			8	Sensor Switch	WSX PFD D WH	Line Voltage Wall Switch Dual Technology Sensor with Dimmer		0	wspxdr8.0m	Absolute	1	0	100%		
	PP			0	HLIGHT	HPFB D	night Power Pack		0	hpfbdr0.0m	Absolute	1	0	100%		
	\$1			0	HLIGHT	HPDR XX	Wall/Post Push-Button On/Off Low Voltage Control, Single Channel		0	hpdr00.0m	Absolute	1	0	100%		
	\$2			0	HLIGHT	HPDR DK XX	Wall/Post Push-Button On/Off/Dimmer Low Voltage Control, Single Channel		0	hpdrdk0.0m	Absolute	1	0	100%		
	\$3			0	HLIGHT	HPDR KL DK XX	Wall/Post Push-Button Scene Controller, 4-Scene with Raise/Lower		0	hpdrkl0.0m	Absolute	1	0	100%		

LEGEND

13 - 2'x4' LED 2 lamp, 18 - 2'x4' LED 2 lamp, 21 - 2'x4' LED 2 lamp, 26 - 2'x4' LED 2 lamp, 33 - 2'x4' LED 2 lamp, Total = 111 fixtures

5 - 1'x4' LED 2 lamp, 14 - 1'x4' LED 2 lamp, Total = 19 fixtures

5 - 1'x4' LED 2 lamp, Total = 5 fixtures

18-2'x4', 32w T8-4 bulb fixtures, replaced with 18-2'x4' LED 2 bulb fixtures. This is a one for one application.

26-2'x4', 32w T8-4 bulb fixtures, replaced with 26-2'x4' LED 2 bulb fixtures. This is a one for one application.

13 - 1'x4' 32w T8 fixtures, replaced with 13-2'x4' LED 2 bulb fixtures. This is a one for one application.

42 - 1'x4' 32w T8-2 bulb fixtures, replaced with 21 centered 2'x4' LED 2 bulb fixtures. We are reducing fixture count in this area.

33-2'x4', 32w T8-4 bulb fixtures, replaced with 33-2'x4' LED 2 bulb fixtures. This is a one for one application.

5-1'x4', 32w T8-2 bulb fixtures, replaced with 5 1'x4' LED 2 bulb fixtures. The acoustic ceiling remains in this area.

5-1'x4', 32w T8-2 bulb fixtures, replaced with 5 1'x4' LED 2 bulb fixtures. The acoustic ceiling will be removed from this area. Additional air craft cable to hang fixtures is needed.

14 - 1'x4' 32w T8-2 bulb fixtures, replaced with 14 1'x4' LED 2 bulb fixtures. This is a one for one application.

KJHS Geothermal Project Ceiling Replacement & Lighting Upgrades

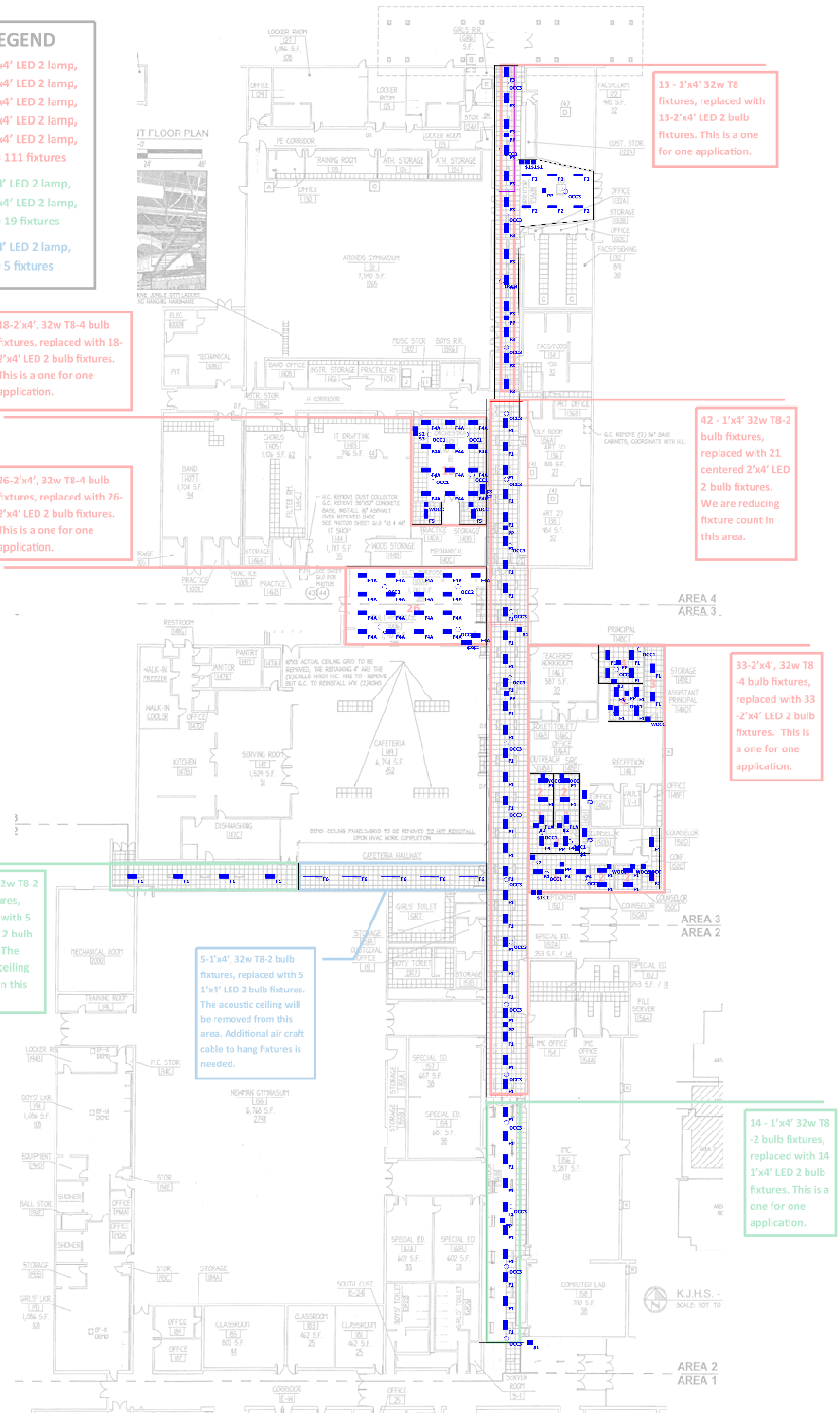

Statistics

Description	Symbol	Qty	Min	Max	Avg
144A	+	35 R, 54 R	17.7	32.1	23.1
148B	+	35 R, 54 R	17.7	32.1	23.1
148E	+	23 R, 47 R	15.6	29.1	20.6
150A	+	46 R, 63 R	29.2	2.1	1.6
150C	+	46 R, 63 R	29.2	2.1	1.6
150E	+	32 R, 58 R	16.8	3.6	2.6
Asst. Principal	+	43 R, 60 R	25.3	2.4	1.7
Band Practice Rm 1	+	26 R, 40 R	15.6	2.7	1.7
Band Practice Rm 2	+	26 R, 40 R	15.6	2.7	1.7
Band Room	+	45 R, 59 R	24.3	2.5	1.9
Center Walkway	+	25 R, 49 R	13.6	1.3	1.3
Mech Area	+	32 R, 41 R	15.9	2.2	1.7
Mech Area Ceiling Tile Area	+	15 R, 45 R	3.6	15.0	5.0
Multi Purpose 1006	+	45 R, 62 R	15.6	4.1	3.0
North Hallway	+	26 R, 53 R	13.6	6.6	3.3
Nurse 148	+	36 R, 61 R	17.7	3.6	2.1
Nurse Sm. Rm.	+	30 R, 48 R	18.0	2.7	1.7
Nurses Corridor	+	13 R, 25 R	1.8	5.0	3.0
Principal	+	50 R, 63 R	31.3	2.0	1.6
Reception	+	34 R, 65 R	14.8	4.0	2.4
South Hallway 144	+	23 R, 51 R	5.9	10.2	4.6

Note
Based on Fixture Mounting Height of X' with Reflectances of 80/50/20

This lighting layout approximates the light levels for the area defined within this document. The computer analysis we provide is useful in the determination of the design parameters of this application. KSA Central LLC assumes no responsibility for the accuracy, validity, or the applicability of the results from this layout.

Plan View
Scale: 1" = 20'

Kingsley Junior High Lighting/Controls Layout no FC Levels

Designer: Nick Anderson
Date: 2/3/2020
Scale: As Shown on 36x48" Arch E
Drawing No.:
Summary: